

# Field Configurable Sensing Edge

CPT215



## TOUCH SENSITIVE SIGNALING

CPT215 is a UL 325 recognized sensing edge designed for on-site configuration and assembly. Upon contact with an obstruction, the edge signals operator controls to immediately stop and/or reverse motion.

Easily cut the CPT215 extrusion to the required length at the job site, ensuring a quick turnaround with no lead time. The advanced design of the CPT215 cap, cage, and plug provides a sealed assembly, providing a no-glue solution. This feature not only provides flexibility for field length adjustment but also allows users to choose the appropriate termination for monitoring compatibility with the operator. Experience the efficiency and adaptability of CPT215 for seamless integration into your safety systems.

*ENHANCED  
END DESIGN*

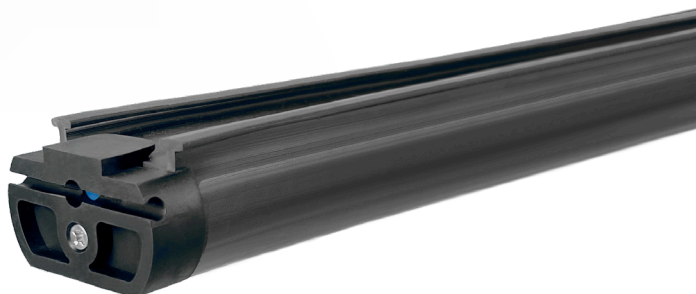

### APPLICATIONS

- Motorized doors
- Automated gates
- Machinery pinch points
- Scissor lifts
- Automated storage/retrieval

### FEATURES

- Easy to install
- Optimum size for 2-inch thick surfaces
- Enhanced adhesive-free end cap design streamlines field configuration, installation, and adjustments
- Bulk extrusion and end kits available for on-site assembly, eliminating lead times
- Versatile monitoring configurations
- Sealed assembly impervious to dust and debris
- Mounting channel options offer versatility
- Advanced conductive polymer technology for efficient and reliable performance
- Mounts vertically or horizontally
- UL 325 Recognized Component
- CE certificate of compliance
- 2-year warranty
- Made in USA of U.S. and imported parts

610-869-4422

[www.milleredge.com](http://www.milleredge.com)





# Field Configurable Sensing Edge

## CPT215

### GENERAL SPECIFICATIONS

Color	● Black
Maximum Length	50 ft.
Sensitivity	Nominal 3-5 lbf
Lead Wire	12 in., 22 gauge, SJTO
Wire Outlet Location	Universal end plug
Electrical Maximum	24 volts AC/DC, 1/2 amp
Electrical Configuration	Normally open non-terminated or terminated: 8.2K ohm, 10K ohm, or diode capacitor options
Operating Temperature	Meets or exceeds UL requirement
Materials	Extrusion: Flexible PVC, conductive polymer, Ends: Molded polymer
Contact Element	Conductive polymer
Agency Approvals	us UL 325 Recognized Component certificate of compliance

### OPTIONS

#### Configurations:

- Monitored
  - 2-Wire
  - 8.2K ohm resistor (green)
  - 10K ohm resistor (blue)
  - Diode capacitor (red)
- Non-Monitored
  - 2-Wire (black)

#### Other Options:

- Bulk roll
- Edge kits
- End kits (monitored and non-monitored options)
- Mounting channels

### OPTIONAL MOUNTING CHANNELS

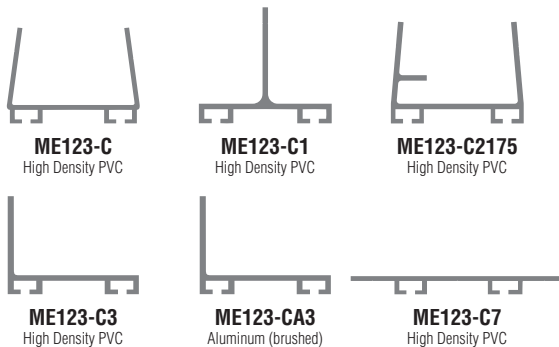

### DIMENSIONS

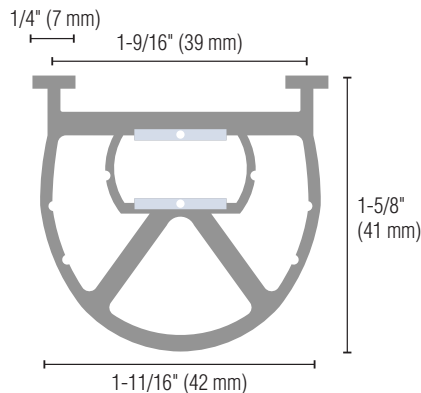

### ASSEMBLY

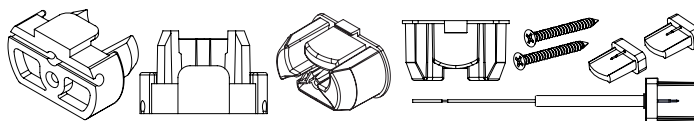
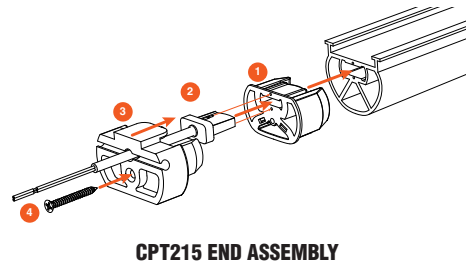

**CPT215 END KIT**

- (2) Caps, (2) Cages, (1) Wired Plug, (1) Monitored End Plug,  
(1) Non-Monitored End Plug, (2) Stainless Steel Screws

### RELATED PRODUCTS

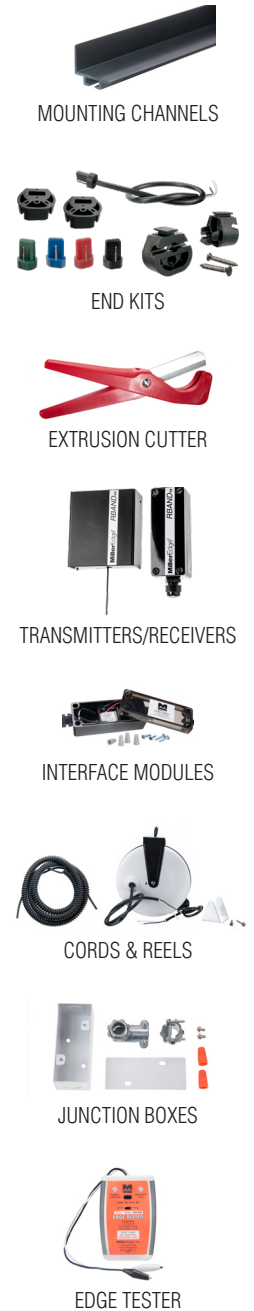

Contact Miller Edge to ensure compatibility.

© Miller Edge, Inc. All rights reserved  
CPT215\_Spec\_20240627